

Tenth Annual

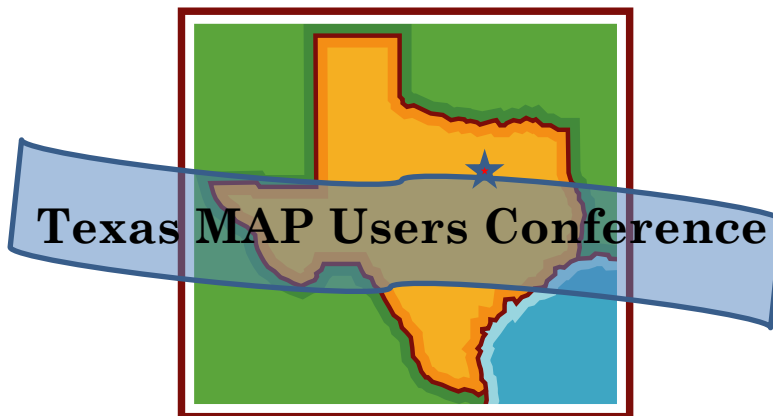

Thursday, February 9, 2017

The Sockwell Center

Plano ISD, Plano, TX

8:30 am to 3:15 pm



Northwest Evaluation Association

Partnering to help all kids learn



**Plano Independent School District
Assessment and Accountability
Plano, Texas**

“Save the Date”... for next years

11th Annual Texas MAP Users Conference

Thursday, February 15, 2018

Make sure to check back often to the conference website for additional information.

www.PISD.edu/TXMAPConference

****Wi-Fi access is available to PISD guests.**

**10th Annual
TEXAS MAP USERS' CONFERENCE**

SCHEDULE AT A GLANCE

7:30 - 8:25 am	Registration & Breakfast
8:30 - 9:20 am	Session I
9:30 - 10:20 am	Session II
10:30 - 11:20 am	Session III
11:40 - 12:50 pm	Luncheon
1:00 - 1:50 pm	Session IV
2:00 - 3:00 pm	General Session: Kathy Dyer Activating Your Learners!
3:00 - 3:15 pm	Door Prize Drawings

**Thank you to our sponsors:
Plano ISD
Northwest Evaluation Association**

Special Session:
8:30 am - 11:20 am Experience a MAP Test - Brazos Lab

Please stop by the front door on your way out today!
Thank you for coming and we hope to see you again next year.

**** Wi-Fi access is available to PISD guests.**

Presenters

- **Vicky Billings** - Account Manager, NWEA
- **Dr. Paul Dabbs** - Assistant Director, Research and Campus Data Support, Plano ISD
- **Aaron Daffern** - Aaron Daffern Consulting
- **Kathy Dyer** – Senior Consultant, Professional Development, NWEA
- **Mike Harris** - Web based MAP Product Manager, NWEA
- **Kathy Howell** - Glen Rose ISD
- **Dave Irby** - Senior Account Executive, NWEA
- **Kimberly Lammers** - Uplift Education
- **Lydia Li** - Data Management Coordinator, Plano ISD
- **Susan Klassen** - Senior Account Executive, NWEA
- **Ellen McLoughlin** - Carrollton/Farmers Branch ISD
- **Diane Miller** - Achieve 3000
- **Kim Ramsey** - Classworks
- **Jennifer Ruth** - Elementary Achievement Specialist, Plano ISD
- **Kathy Schadt** - Assessment Technical Assistant, Plano ISD
- **Kristi Snow** - Glen Rose ISD
- **John Tedford** - Secondary Achievement Specialist, Plano ISD
- **Jeremy Wagner** - Lubbock-Cooper ISD
- **Susan Wright** - Glen Rose ISD

Vendor Exhibits

8:15 am – 2:00 pm

NWEA

Have your questions answered about MAP informational session.

Facilitators: Dave Irby, Vicky Billings, Susan Klassen, Mike Harris

Achieve 3000

Differentiated Instruction, Accelerated Learning

The world's most advanced and only patented online model of differentiated instruction available today. Developing the literacy capacities of all learners through anytime, anywhere learning has never been easier. Whether preparing for the rigor of new high-stakes assessments or building a cross-circular path to college and career readiness, Achieve 3000 has the solutions to help you achieve your goals.

Facilitators: Diane Miller, Jesse Rodriguez

Classworks

Flexible. Blended. Powerful.

Classworks provides powerful K-8 classroom and individualized digital instruction to help teachers improve student learning.

Facilitator: Kim Ramsey

Edgenuity

Edgenuity is a leading provider of K-12 online and blended learning solutions including online courses, credit recovery, intervention, test preparation and more. Discover how Edgenuity courses can be used to help students meet the Texas Graduation requirements of the Foundations High School Program and see how our curriculum and powerful online tools prepare Texas Students for college and career success.

Facilitator: Zach Henningsen, Billy McCrary

Waggle: Triumph Learning

Waggle is an online learning management software that provides lessons, games and assessments in the adaptive learning landscape. Waggle for Texas is teacher-directed TEKS-based content for instruction, reinforcement, and practice.

Facilitator: Cathy Caldwell

We would like to thank all our vendors for their generosity in providing the door prizes for the drawing at the end of the day.

You must be present to win!

****Wi-Fi access is available to PISD guests**

MAP Update - What's New and coming to MAP!

Dallas Room

Michael Harris – NWEA

Come explore the new standards report and other tools that are now in MAP, see what is coming in the near future, and discuss with your colleagues how you will use it.

*Repeated at Session II

The ABC's of MAP

Austin Room

Dave Irby, NWEA

This session is for those who are new to Measures of Academic Progress (MAP) and want to understand the basics. The presentation will provide an introduction to MAP including a discussion of the RIT scale, normative and comparative data, STAAR proficiency projections, the College Explorer Tool, the primary ways districts and schools use MAP data, and a preview of basic reports.

Build Student Confidence to Get Better MAP Results: Strategies for Pushing Students to Understanding

San Antonio Room

Aaron Daffren – Aaron Daffren Consulting

MAP results are not very useful if the tests do not accurately reflect student abilities. How can teachers help their students gain the confidence needed to push through the difficulty of the MAP test? How can students be prepared to try their very best and not give up when the test questions get too hard? Learn two teaching strategies that you can use in your class the very next day to help build student confidence and motivation. The Hot Seat will help students perform well under pressure by exposing them to safe levels of dynamic tension. Target in the Middle will help students assess their own understanding of a subject, learn from others, and give teachers valuable formative data.

*Repeated at Session III

Leveraging MAP for Science Teaching Strategies

Colorado/Rio Grande Room

Jeremy Wagner – Lubbock/Cooper ISD

In this session we will look at how to utilize MAP results and resources to pinpoint areas of growth for your students. Several teaching strategies will also be explored to fold into your science classroom without needing to completely change your entire classroom. Strategies include methods to utilize small groups, engage students in content oriented discussion, questioning, and technology integration ideas. Participants will experience the strategies much like the students in their classrooms would and need to bring a personal device (i.e. cell phone, laptop, tablet) for this session.

*Repeated at Session II

Taking Action with MAP Data: Training School Leaders and Teachers to Make Instructional Improvements with Their Data

Trinity Room

Kimberly Lammers – Uplift Education

You've received your MAP scores...now what? School leaders know that instructional choices should be informed by scholar data. In this session you will have the opportunity to learn how to train your leaders and teachers to analyze key scholar data, strategize instructional improvements, and create an action plan to ensure scholars are on-track to reaching their instructional goals. While looking at numbers and data systems can sometimes feel overly technical, this training provides a framework for analyzing MAP data, leaving educators feeling confident and with individualized plans for their scholars. This session is intended for all audiences, beginners through advanced MAP users, looking for resources and a framework to use their data to improve instructional practices.

Build Math Justifications to Develop Strong Math Thinkers

Pecos Lab

Kim Ramsey - Classworks

When it comes to math, how do you know if your students are truly getting it? Part of building mathematical communications skills includes the ability to build justifications. Math practice standards call for students to not only figure out the problem, but communicate how they solved it, and why their answer is correct – using evidence.

Attend our session to learn best practices for using digital math problem-solving activities to develop conceptual understanding and reasoning skills leading to good justifications. Review three important steps: scaffolding, setting expectations, and providing personalized feedback. Leave with actionable ways to use these steps to develop students' ability to make connections between concepts, communicating their understanding rather than just their ability to arrive at a solution following a procedure.

*Repeated at Session IV

Experience a MAP Test

Brazos Lab

Lydia Li, Data Management Coordinator, and
Kathy Schadt, Assessment Technical Assistant, Plano ISD

Take a sample MAP Test just like your students.

*Repeated at Session II & III

Student Goal Setting Using MAP and College Readiness Data

Dallas Room

Susan Klassen – NWEA

One of the most important activities teachers can use MAP data for is to engage their students in goal setting. This session will give teachers specific strategies for setting targets for academic growth with students in all grades and developing action plans for success.

***Repeated at Session III**

Effective Analysis of the Data that Positively Impacts Student Success

Austin Room

Susan Wright, Kathy Howell, Kristi Snow – Glen Rose ISD

This session topics will include the following:

1. Setting up the testing environment to get valid test results
2. Effective analysis of data that positively impacts student success
3. Students participating in goal setting and strategies to meet the goals

***Repeated at Session III**

What is new and coming soon to MAP

San Antonio Room

Mike Harris - NWEA

Come explore the new standards report and other tools that are now in MAP, see what is coming in the near future, and discuss with your colleagues how you will use it.

***Repeated at Session I**

Why do I have to take another test? How to Talk with Students About MAP Testing

Colorado/Rio Grande Room

John Tedford - Plano ISD

What do you tell your students about MAP testing? Did you know that a student's perception of an assessment can significantly impact his/her performance? How can you "spin" the MAP to maximize student performance? Learn effective ways to communicate the nature and purpose of MAP using dialogue and analogies that kids can understand and relate to. Participants will be provided with specific, concise language to use when discussing MAP with their students along with a Power Point presentation designed for personal classroom use.

Leveraging MAP for Science Teaching Strategies

Trinity Room

Jeremy Wagner – Lubbock/Cooper ISD

In this session we will look at how to utilize MAP results and resources to pinpoint areas of growth for your students. Several teaching strategies will also be explored to fold into your science classroom without needing to completely change your entire classroom. Strategies include methods to utilize small groups, engage students in content oriented discussion, questioning, and technology integration ideas. Participants will experience the strategies much like the students in their classrooms would and need to bring a personal device (i.e. cell phone, laptop, tablet) for this session.

***Repeated at Session I**

Using Your MAP Data to Provide Targeted Instruction with Achieve3000

Pecos Lab

Diane Miller – Achieve3000

You have done your assessment and reviewed all of your MAP data, but now what do you do? Using the integration between NWEA and Achieve3000, you can now assign targeted instruction that provides additional instruction and practice on the skills students need at their exact reading level! Join us for a hands-on session as we log in and see the magic of these two programs working together!

***Repeated at Session IV**

Experience a MAP Test

Brazos Lab

**Lydia Li, Data Management Coordinator, and
Kathy Schadt, Assessment Technical Assistant, Plano ISD**

Take a sample MAP Test just like your students.

***Repeated at Session I & III**

Tapping Into the Predictive Power of MAP: The relationship between MAP and STAAR

Dallas Room

Jennifer Ruth - Plano ISD

NWEA provides a linking study that allows us to see the relationship between MAP and STAAR. Understanding the linking study can give you powerful information about which students are more or less likely to be successful on STAAR. Knowing this information early in the school year allows more time to tailor instruction to meet the needs of the student and minimizes the number of students who may need intervention later in the school year. Plano ISD has analyzed the relationship between MAP and STAAR with our local data. We have found that using local data helps to increase the confidence that teachers have with the data. Our analysis of the MAP and STAAR relationship has found MAP to be an accurate predictor of STAAR scores. We will share our analysis and how we use this information to communicate with parents and teachers.

Student Goal Setting Using MAP and College Readiness Data

Austin Room

Susan Klassen – NWEA

One of the most important activities teachers can use MAP data for is to engage their students in goal setting. This session will give teachers specific strategies for setting targets for academic growth with students in all grades and developing action plans for success.

*Repeated at Session II

On your Mark, Get Set, Get Ready to MAP Test

San Antonio Room

Ellen McLoughlin – Carrollton/Farmers Branch ISD

Are your students and staff ready to MAP test? Learn the importance of providing training to staff so their students will be ready to test. Learn how MAP tests work, how to prepare students, and the importance of the testing

Effective Analysis of the Data that Positively Impacts Student Success

Colorado/Rio Grande Room

Susan Wright, Kathy Howell, Kristi Snow – Glen Rose ISD

This session topics will include the following:

1. Setting up the testing environment to get valid test results
2. Effective analysis of data that positively impacts student success
3. Students participating in goal setting and strategies to meet the goals

*Repeated at Session II

Build Student Confidence to Get Better MAP Results: Strategies for Pushing Students to Understanding

Trinity Room

Aaron Daffren - Aaron Daffren Consulting

MAP results are not very useful if the tests do not accurately reflect student abilities. How can teachers help their students gain the confidence needed to push through the difficulty of the MAP test? How can students be prepared to try their very best and not give up when the test questions get too hard? Learn two teaching strategies that you can use in your class the very next day to help build student confidence and motivation. The Hot Seat will help students perform well under pressure by exposing them to safe levels of dynamic tension. Target in the Middle will help students assess their own understanding of a subject, learn from others, and give teachers valuable formative data.

*Repeated at Session I

The Link Between Probing Questions and Student Learning

Pecos Lab

Kim Ramsey - Classworks

Probing questions are a feature of the Socratic method of using questions and answers to challenge assumptions and expose contradictions, which leads to new knowledge (Cotton). Probing questions are a key component of Close Reading. Empirical evidence supports the theory that student learning increases when thinking is made visible. To build critical thinking, students need to be able to articulate and illustrate how they think about concepts, what strategies or information they use to build understanding, and why they selected a particular strategy or approach. "Learning is a consequence of thinking and students' understanding of content increases when they think through and with the concepts and information they are studying" (Ritchhart & Perkins, 2008. Activities built by NWEA partners to support teachers during whole group, small group and individualized learning.

Experience a MAP Test

Brazos Lab

Lydia Li, Data Management Coordinator, and
Kathy Schadt, Assessment Technical Assistant, Plano ISD

Take a sample MAP Test just like your students.

*Repeated at Session I & II

From Class Report to NEW Student Profile – What you need to know and will love

Dallas, Austin, San Antonio Room

Vicky Billings – NWEA

Both teachers brand new to MAP and those using MAP for a longer time will benefit from this review of the Class Report, as well as a thorough treatment of the new, award-winning Student Profile Report, listed under Next-Generation Reports in your MAP Reports listing. Learn how to interpret NWEA's Normative Data in relation to your student's RIT and the real reason to distinguish between Means and Medians on your class report. Then, see how the data gleaned from the Class Report can be managed for each student in one, easy-to-view Student Profile, with one-click access to each subject area, personalized Learning Continuum Statements and easy navigation between students

Language Proficiency and Academic Achievement

Colorado/Rio Grande Room

Paul Dabbs - Plano ISD

Understanding the academic development of a student is best accomplished through multiple sources, that is, a preponderance of evidence. This study brings together TELPAS, MAP, and STAAR data to give educators confidence in the information that these standardized assessments provide to improve instruction and programs. TELPAS identifies academic language proficiency which **provides access** to academic achievement. This study reviewed longitudinal data from Plano ISD to better understand the rate of language proficiency development and academic growth as measured by MAP. The relationship between English language proficiency in writing is also compared to achievement on MAP Language Usage. Relationships to STAAR are also demonstrated in each area.

Build Math Justifications to Develop Strong Math Thinkers

Trinity Room

Kim Ramsey - Classworks

When it comes to math, how do you know if your students are truly getting it? Part of building mathematical communications skills includes the ability to build justifications. Math practice standards call for students to not only figure out the problem, but communicate how they solved it, and why their answer is correct -- using evidence. Attend our session to learn best practices for using digital math problem-solving activities to develop conceptual understanding and reasoning skills leading to good justifications. Review three important steps: scaffolding, setting expectations, and providing personalized feedback. Leave with actionable ways to use these steps to develop students' ability to make connections between concepts, communicating their understanding rather than just their ability to arrive at a solution following a procedure.

Using Your MAP Data to Provide Targeted Instruction with Achieve3000

Pecos Lab

Diane Miller – Achieve3000

You have done your assessment and reviewed all of your MAP data, but now what do you do? Using the integration between NWEA and Achieve3000, you can now assign targeted instruction that provides additional instruction and practice on the skills students need at their exact reading level! Join us for a hands-on session as we log in and see the magic of these two programs working together!

General Session

2:00 pm – 3:00 pm Main Hall



Kathy Dyer, Ed.D. Senior Consultant, Professional Development

With 24 years in education, Kathy Dyer has taught K through graduate school, serving as a district-level assessment coordinator and secondary principal, and coach to teachers and school and district-level leadership groups. In her current capacity as Sr. PD Specialist on NWEA's PD Design team, her work focuses on data use, coaching, school improvement planning, assessment literacy, and formative instructional practices. Kathy is a regular contributor to the blogs on AssessmentLiteracy.org and [Teach. Learn. Grow.](http://Teach.Learn.Grow)

Activating Your Learners!

Why does assessment matter to learners? How do you get them engaged in creating actionable data for themselves and us? The culture of learning in our classrooms can help build autonomy for our students. This culture includes trust, mindset, engagement and structures. One of the structures in our classroom is assessment. Figuring out how to use assessment as another learning tool empowers students to set goals and meet them. Let's connect your use of MAP to this culture of learning where students create and own their data.

My Conference Schedule

10th Annual Texas MAP Users Conference - February 9, 2017 - Plano, Texas

Check each session in which you participated. Turn into your principal or administrator for Professional Development hours.

NAME _____ CAMPUS _____

Time	Session Title	Presenter(s)	Check Box
8:30 – 9:20 am	What is new and coming soon to MAP	Mike Harris	
8:30 – 9:20 am	The ABC's of MAP	Dave Irby	
8:30 – 9:20 am	Build Student Confidence to Get Better MAP Results: Strategies for Pushing Students to Understanding	Aaron Daffern	
8:30 – 9:20 am	Leveraging MAP for Science Strategies	Jeremy Wagner	
8:30 – 9:20 am	Taking Action with MAP Data: Training School Leaders and Teachers to Make Instructional Improvement with Data	Kimberly Lammers	
8:30 – 9:20 am	Build Math Justifications to Develop Strong Math Thinkers	Kim Ramsey	
8:30 – 9:20 am	Experience a MAP Test	Lydia Li Kathy Schadt	
9:30 – 10:20 am	Student Goal Setting Using MAP and College Readiness Data	Susan Klassen	
9:30 – 10:20 am	Effective Analysis of the Data that Positively Impacts Student Success	Susan Wright, Kathy Howell, Kristi Snow	
9:30 – 10:20 am	What is new and coming soon to MAP	Mike Harris	
9:30 – 10:20 am	Why do I have to take another test? How to talk with Students about MAP Testing	John Tedford	
9:30 – 10:20 am	Leveraging MAP for Science Strategies	Jeremy Wagner	
9:30 – 10:20 am	Using Your MAP Data to Provide Targeted Instruction with Achieve3000	Diane Miller	
9:30 – 10:20 am	Experience a MAP Test	Lydia Li Kathy Schadt	
10:30 – 11:20 am	Tapping into the Predictive Power of MAP: The relationship between MAP and STAAR	Jennifer Ruth	
10:30 – 11:20 am	Student Goal Setting Using MAP and College Readiness Data	Susan Klassen	
10:30 – 11:20 am	On your Mark, Get Set, Get Ready to MAP Test	Ellen McLoughlin	
10:30 – 11:20 am	Effective Analysis of the Data that Positively Impacts Student Success	Susan Wright, Kathy Howell, Kristi Snow	
10:30 – 11:20 am	Build Student Confidence to Get Better MAP Results: Strategies for Pushing Students to Understanding	Aaron Daffern	
10:30 – 11:20 am	The Link Between Probing Questions and Student Learning	Kim Ramsey	
10:30 – 11:20 am	Experience a MAP Test	Lydia Li Kathy Schadt	
1:00 – 1:50 pm	From Class Report to New Student Profile – What you need to know and will love	Vicky Billings	
1:00 – 1:50 pm	Language Proficiency and Academic Achievement	Paul Dabbs	
1:00 – 1:50 pm	Build Math Justifications to Develop Strong Math Thinkers	Kim Ramsey	
1:00 – 1:50 pm	Using Your MAP Data to Provide Targeted Instruction with Achieve3000	Diane Miller	

**** Wi-Fi access is available to PISD guests.**

Sockwell Center Layout

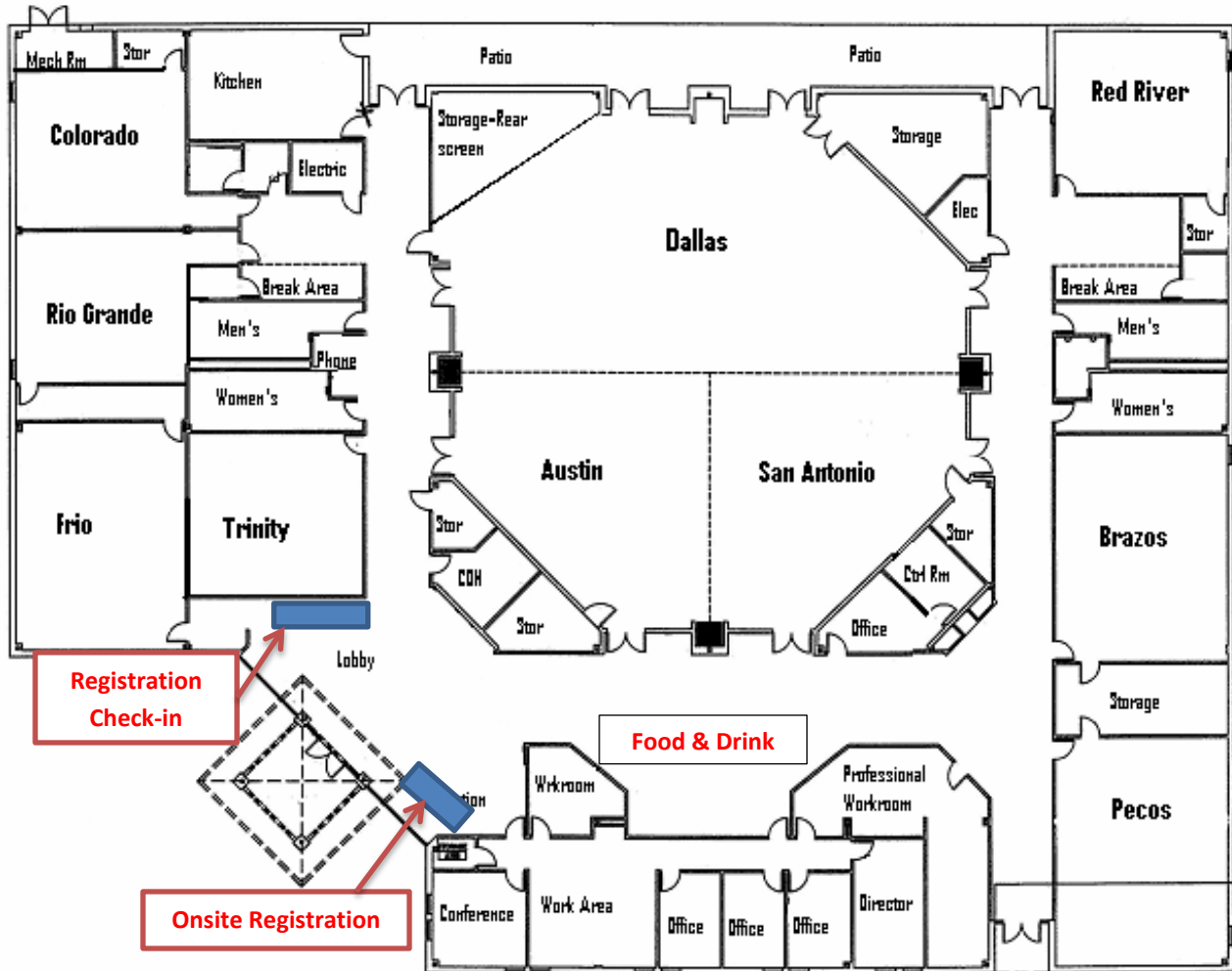

**Plano Independent School District
Assessment and Accountability
Plano, Texas**

Parking at the Sockwell Center is limited. Overflow parking is across the street at Willow Bend Mall.